

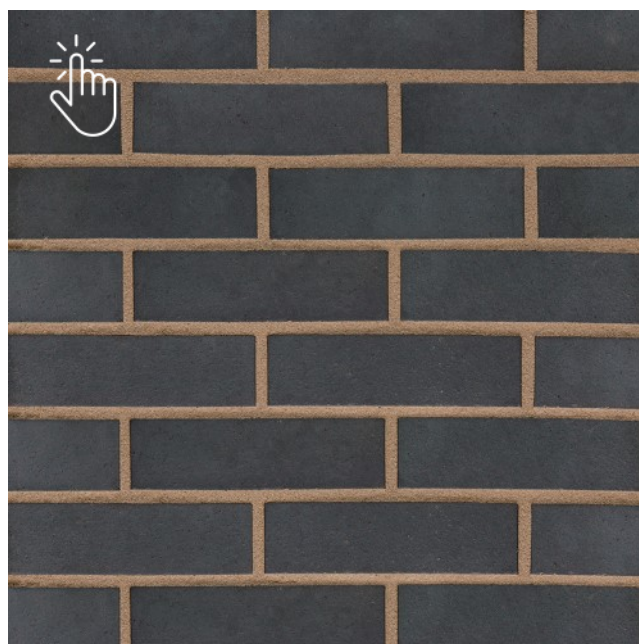

Staffordshire Smooth Blue Perforated

Product Technical Information Sheet

Wienerberger Code	24331020 (K201)
Production Plant	Kingsbury
Manufacture	Extruded/Wirecut
Configuration	Perforated
Colour	Blue
Appearance	Smooth
Work Size (mm)	215 x 102.5 x 65
Pack Quantity	400 No.
Individual Dry Brick Weight (kg)	2.6



Technical Properties to BS EN 771-1

Size Tolerance (Mean/Range)	T2/R1
Gross Dry Density (kg/m ³ /Tolerance)	1800 (D1)
Compressive Strength (N/mm ²)	≥75
Thermal Conductivity (W/(m·K))	P=90% 0.84
λ _{10,dry,unit} value (EN 1745 tabulated: S1)	
Durability Designation	F2
Water Absorption (%)	≤7
Initial Rate of Water Absorption (kg/(m ² ·min))	Min. 0.0 Max. 0.5
Active Soluble Salts	S2
Reaction to Fire	Class A1

Issue Date: 07/09/2020

Technical data correct at time of issue. Individual dry brick weights can vary and are for guidance only. Any questions regarding this data should be referred to the Wienerberger Technical Department. Due to the limitations of screen and print colour representation of product images it is advised that brick samples are viewed prior to ordering.

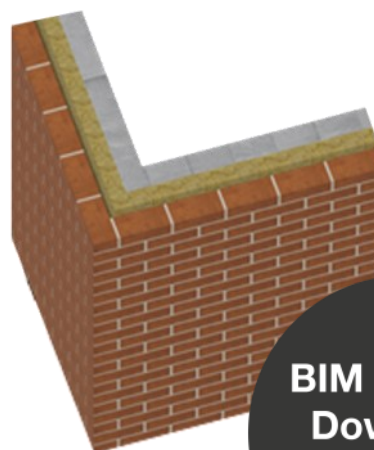

**BIM Objects
Download**

