



Hurstwood Multi

Product Technical Information Sheet

| | |
|----------------------------------|------------------------|
| Wienerberger Code | 24250190 |
| Production Plant | Warnham |
| Manufacture | Soft Mud Moulded Stock |
| Configuration | Frogged |
| Colour | Yellow Multi |
| Appearance | Flat |
| Work Size (mm) | 215 x 102.5 x 65 |
| Pack Quantity | 500 No. |
| Individual Dry Brick Weight (kg) | 2.2 |

Technical Properties to BS EN 771-1

| | |
|--|-------------------|
| Size Tolerance (Mean/Range) | T1/Rm |
| Gross Dry Density (kg/m ³ /Tolerance) | 1500 (D1) |
| Compressive Strength (N/mm ²) | ≥12 |
| Thermal Conductivity (W/(m·K)) λ _{10,dry,unit} value (EN 1745 tabulated: S1) | P=90% 0.51 |
| Durability Designation | F2 |
| Water Absorption (%) | ≤20 |
| Initial Rate of Water Absorption (kg/(m ² ·min)) | Min. 0.7 Max. 3.0 |
| Active Soluble Salts | S2 |
| Reaction to Fire | Class A1 |

Issue Date: 09/09/2020

Technical data correct at time of issue. Individual dry brick weights can vary and are for guidance only. Any questions regarding this data should be referred to the Wienerberger Technical Department. Due to the limitations of screen and print colour representation of product images it is advised that brick samples are viewed prior to ordering.

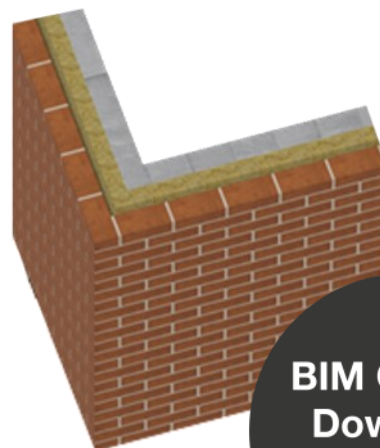

**BIM Objects
Download**

