



## Sahara Buff

### Product Technical Information Sheet

Wienerberger Code	24170560
Production Plant	Denton
Manufacture	Extruded/Wirecut
Configuration	Perforated
Colour	Buff
Appearance	Dragfaced
Work Size (mm)	215 x 102.5 x 65
Pack Quantity	400 No.
Typical Pack Weight	840 kg

### Technical Properties to BS EN 771-1

Size Tolerance (Mean/Range)	T2/R1
Gross Dry Density (kg/m <sup>3</sup> /Tolerance)	1460 (D1)
Compressive Strength (N/mm <sup>2</sup> )	≥50
Thermal Conductivity (W/(m·K))	P=90% 0.69
λ <sub>10,dry,unit</sub> value (EN 1745 tabulated: S1)	
Durability Designation	F2
Water Absorption (%)	≤10
Initial Rate of Water Absorption (kg/(m <sup>2</sup> ·min))	Min. 0.5 Max. 1.0
Active Soluble Salts	S2
Reaction to Fire	Class A1

**Issue Date: 28/07/2020**

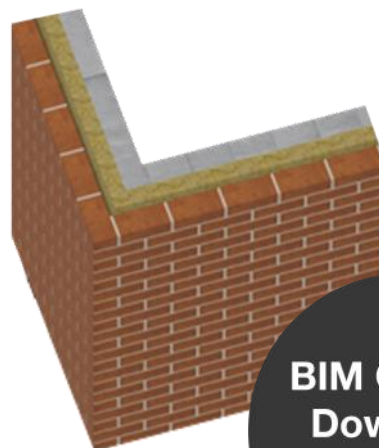
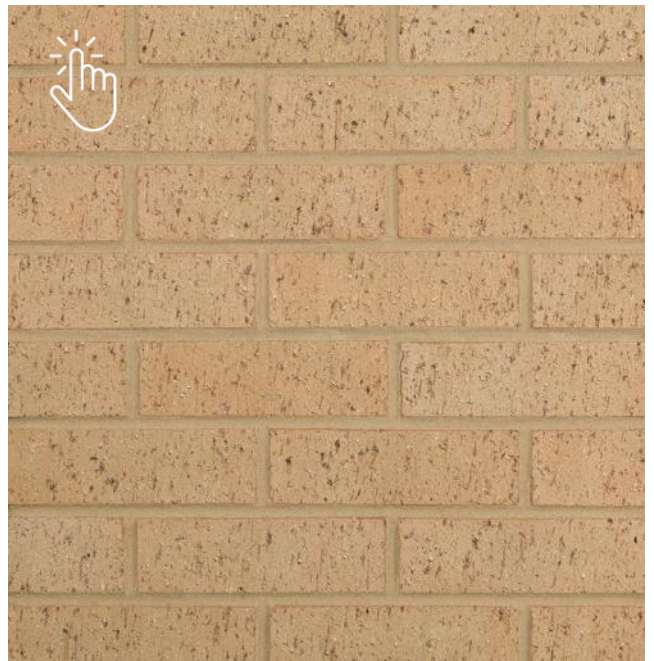

**BIM Objects  
Download**

