

Belfort Pillar Sink Taps Chrome

Useful Information	
Minimum operating pressure	0.1 bar
Maximum operating pressure	5 bar
Guarantee length	2 years

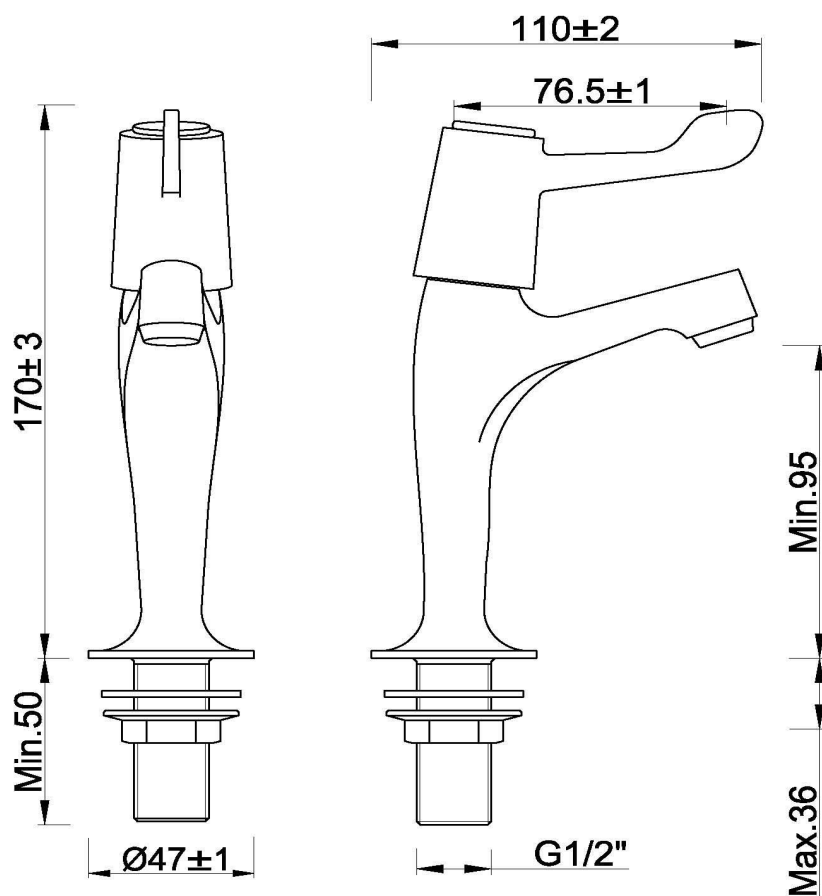

Technical Diagram



Exploded Diagram

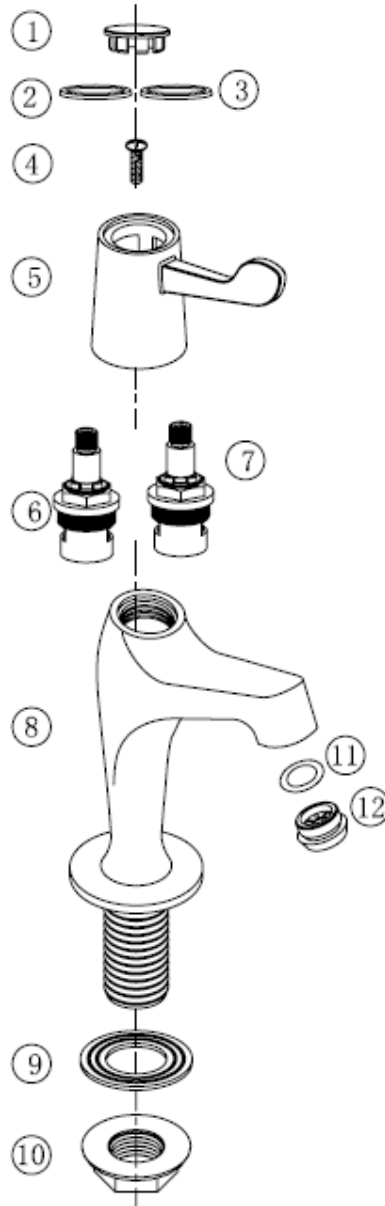

Item Number	Supplier Ref	Item Description	Quantity	Material	Spares Available
1	P51-D	Indice	2	ABS	Yes
2	P51-B H	Indice Seat	1	PE	Yes
3	P51-B C	Indice Seat	1	PE	Yes
4	SC4-12S/L	Screw	2	Stainless Steel	Yes
5	H51-E	Handle	2	ZINC	Yes
6	VS01-C20	1/2" CD Valve	1	BRASS+EPDM+Ceramic Disc	Yes
7	VS01-C20	1/2" CD Valve	1	BRASS+EPDM+Ceramic Disc	Yes
8	M33143-01	Tap Body	2	BRASS	No
9	N08	Washer	2	NBR	Yes

10	N01-C	1/2" Back Nut	2	ZINC	Yes
11	OR003	O Ring	2	EPDM	Yes
12	A01-A	Flow straightener	2	POM	Yes

Flow Rates

Pressure (bar)	Flow rate matrix		
	Hot	Cold	Mixer
	With aerator		
0.1	5.35	5.57	/
0.2	8.56	8.61	
0.3	10.40	10.20	
0.4	12.44	12.08	
0.5	14.02	13.78	
1.0	19.49	18.91	
1.5	23.78	23.21	
2.0	27.80	27.35	
3.0	34.10	33.53	
4.0	39.54	38.97	
5.0	44.41	43.27	

FAQ

What should I do if my tap is dripping/leaking?

Cleaning the valve (if water dripping from tap)

Before carrying out any maintenance, turn off the mains water supply. If unsure contact a qualified tradesman.

1. Remove the cap, grub screw and handles.
2. Remove the valve using a suitable spanner, clean thoroughly under cold water to remove any build up of limescale or debris.
3. If necessary replace the valve.
4. Replace the valve into the body, tighten the valve using a suitable spanner.
5. Replace the handles and indices, tighten the grub screw and re-fit cap to handles.

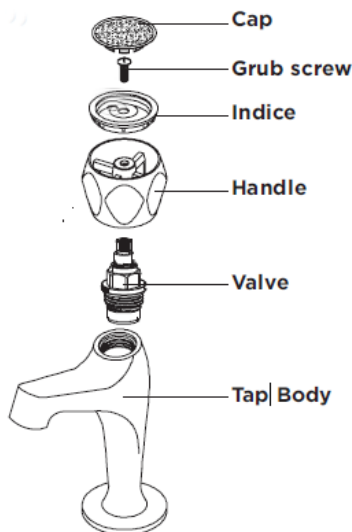

What does the Guarantee Cover?

The Guarantee covers leakage, manufacturing defects and chrome plating.

The guarantee does not cover:

- Damage or defects caused by:
 - general wear and tear (including special non-chrome finishes; components such as filters, seals, 'O'rings and washers)
 - incorrect installation
 - repair using non- PPI parts
 - accidental or wilful misuse
 - corrosion and the use of inappropriate cleaning products.
 - system debris including the build up of limescale (which can be controlled through regular servicing and maintenance).
- Compensation for loss of use of the product or consequential loss of any kind.