

## **Celotex PL4000 is a PIR thermal insulation board bonded to tapered edge plasterboard.**

PL4000 is manufactured from rigid polyisocyanurate (PIR) using a blowing agent that has zero ozone depletion potential (zero ODP) and low global warming potential (GWP).

With Celotex PL4000 you are specifying an insulation board that:

- Can be easily used to help upgrade to current building regulation standards in pitched roof, flat roof and wall applications
- Ideal option for internal solid wall insulation
- Is suitable for both direct bonding ('dot and dab') and mechanically fixed installation techniques
- Featuring an inbuilt vapour control layer
- 15mm option provides ideal solution for window and door reveals
- Is certified under BBA certificate number [16/5357](#)
- Offers the installer maximum flexibility and installation speed due to the tapered edge plasterboard
- Offers the user the ability to install both the insulation and plasterboard in one operation, thus reducing installation times
- Can be used to improve the energy performance of new and existing buildings

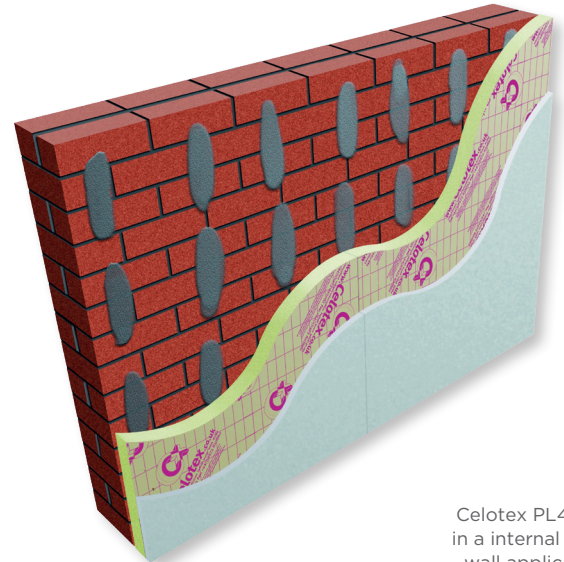

Celotex PL4000 in an internal solid wall application

### Applications

Celotex PL4000 can be specified for use in a variety of applications including:

- [Solid masonry walls](#)
- The 'underneath' layer of insulation in [between and under rafter and joist applications](#)
- [Timber frame lining applications](#)

### Specification clause

The insulation shall be Celotex PL4000 \_\_\_\_mm thick comprising a polyisocyanurate rigid foam insulation core with a thermal conductivity of 0.022 W/mK with aluminium foil/kraft paper facings on both sides bonded to a layer of tapered edge plasterboard. Celotex PL4000 is CFC/HCFC free with zero ODP, low GWP and CE marking. Celotex PL4000 is manufactured in accordance with quality management system ISO 9001 and environmental management system ISO 14001. All products must be installed in accordance with guidance issued by Celotex.

Where building regulation approval is required, you should take advice from your local building control authority and the building designer.

### Technical data

Thickness (mm)	R-value (m <sup>2</sup> K/W)	Maximum Board weight (kg/m <sup>2</sup> )
15 + 12.5	0.70	9.69
25 + 12.5	1.20	9.99
40 + 12.5	1.85	10.46
50 + 12.5	2.30	10.96
60 + 12.5	2.75	11.31
65 + 12.5	3.00	11.48

## Physical properties

	Method	PL4000
<b>Thermal conductivity*</b>	BS EN 12667:2001	0.022 W/mK
<b>Reaction to fire</b>	BS EN 13501-1:2007+A1:2009	B-s1,d0
<b>Flexural strength</b>	Transverse Longitudinal	≥ 160 N ≥ 400 N
<b>Water vapour resistance</b>	(tabulated value)	60

\*Insulation only

## Sustainable insulation

For further information about Celotex' sustainable insulation solutions, visit the sustainability pages of the website at [celotex.co.uk](http://celotex.co.uk)



We have an experienced team of energy assessors who can carry out SAP calculations, water calculations, airtightness testing and much more. [Contact us](#).



Celotex presents a comprehensive range of thermal bridging models featuring our industry leading PIR insulation products. This tool helps you identify the build-up required to reduce heat loss through a typical junction of elements or at openings. [Sign up now](#).

## A bit about us

Celotex products insulate countless buildings the length and breadth of the UK. Providing PIR insulation for over 90 years, our solutions and product development continue to make a difference not just by creating warmth and comfort but by saving energy too. Every day, thousands of professionals choose Celotex. For them, Celotex is insulation. Plus, all Celotex products come with a suite of practical online tools, as well as exceptional before and after sales service.

### Typical U-values

U-values will vary depending on application. To calculate a specific U-value, please visit our online calculator at [celotex.co.uk](http://celotex.co.uk)

### Installation guidelines

For Celotex PL4000 installation details please refer to our online 'applications' pages.

### Further information

If you wish to contact Celotex, please do so through the ['contact us'](#) page on our website.

For information regarding storage, installation and handling of Celotex products, or for health & safety information, please refer to our online 'literature' pages.

Celotex has a policy of continuous product development and reserves the right to alter product designs or specifications without prior notice.

Saint-Gobain Construction Products UK Limited trading as Celotex. Registered Office: Saint-Gobain House, Binley Business Park, Coventry CV3 2TT. Registered in England and Wales No 734396